

"Miami-Dade County Product Control Approved"
Hurricane Shutters and FBC Decorative Shutters
www.bsishutters.com Email: bsishutters@juno.com
Patent No: U.S. 6,996,934 B2 & 7,131,480 B2
2841 Shoreview Drive, Naples FL 34112
Office: 239-774-2025 Fax: 239-774-9483

Hurricane Shutter Systems - Bahama NOA: 09-0122.07 and Colonial NOA: 09-0122.08, Expiration Date: 11/28/2012
Decorative Shutter Systems - Tested and Certified - Florida Building Code TAS 203-94 and ASTM E1233-06

3 & 4 Installation Instructions: Fixed Colonial Shutter

Fixed Colonial Shutter Attached flat to the building next to a window opening for architectural enhancement of the opening, no hinges, and they do not project away from the building

Tools Required:

- Cordless or elec. hammer drill
- 5/16" nut driver and/or Phillips head driver (check size and type of fasteners provided)
- Tape measure
- Level
- Pencil
- Masking tape (to eliminate painting the pencil marks)
- Optional - 2 x 4
- Pilot drill bit (size depends on the type of fasteners)

Items Included:

- All Fasteners - Tap cons w/ drill bit, Lag bolts w/o drill bit

Installation Fixed Colonial Shutter, Fasteners at Head (top) and Sill (bottom) or Jambs (sides)

- Step 1 Determine the position of the shutters to the opening on the building, make a level line where you want the bottom of the shutter, Figure 3, & 4
Head (top) and Sill (bottom): Equal reveal at the top & bottom, Figure 3
Jamb (sides): Panes can be flush with opening jamb (side) or away for opening, your choice, Figure 4
- Step 2 Option - Temporarily anchor a 2 x 4 (6" longer than opening and both panels) to the building - top of 2 x 4 level with line at bottom of shutter (step 1), Figures 3 & 4

Left Shutter through Head & Sill or Jambs

- Step 3 Left Colonial Shutter: Position the panel at the desired location, drill pilot hole for fastener and fasten the top left side to the building, Figures 3 & 4
- Step 4 Option - Place the left shutter onto the 2 x 4, drill pilot hole for fastener and fasten the top left side to the building, Figures 3 & 4
- Step 5 Level the head of the shutter, Figures 3 & 4
- Step 6 Drill pilot holes at the remaining fastener holes, screw the shutter to the building, Figures 3 & 4
- Step 7 Install the plastic plugs at the screw holes, Figures 3 & 4

Right Shutter through Head & Sill or Jambs

- Step 8 Right Colonial Shutter: Repeat Steps 3 to 7
- Step 9 Remove the 2 x 4, patch the holes, and touchup paint if necessary

3-Fixed Colonial Shutter, Head & Sill Attachment

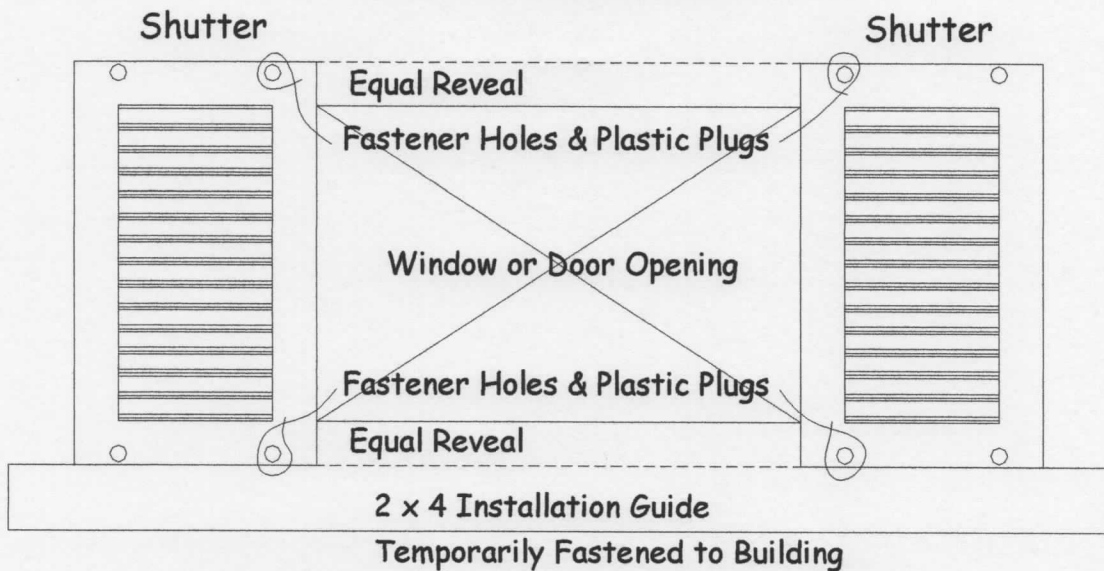

3-Fixed Colonial Shutter, Head & Sill Attachment

Elevation Left Panel

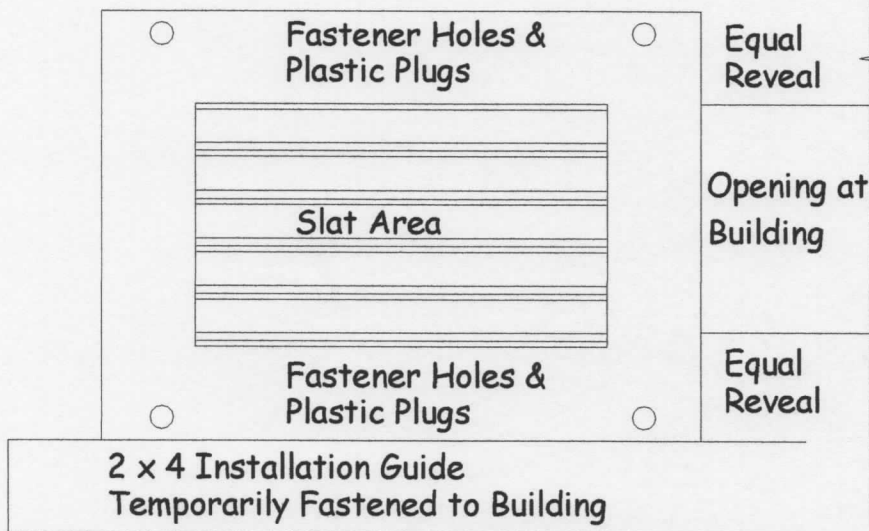

Section

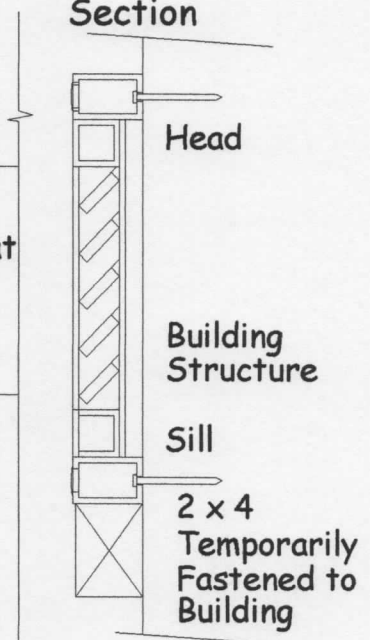

4-Fixed Colonial Shutter, Jamb Attachment

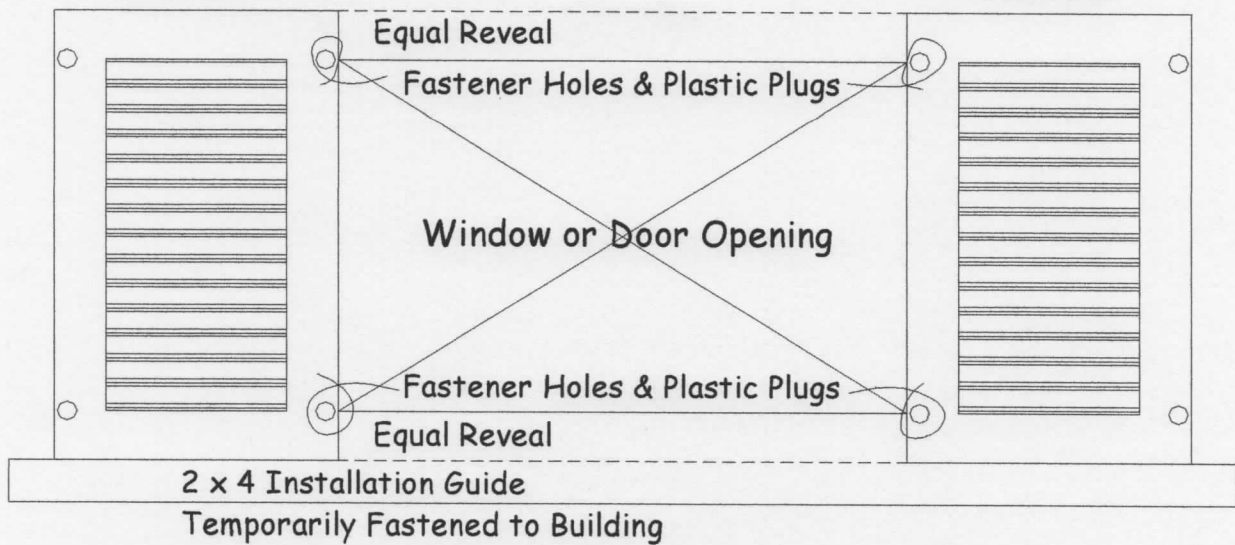

4-Fixed Colonial Shutter, Jamb Attachment

Elevation Left Panel

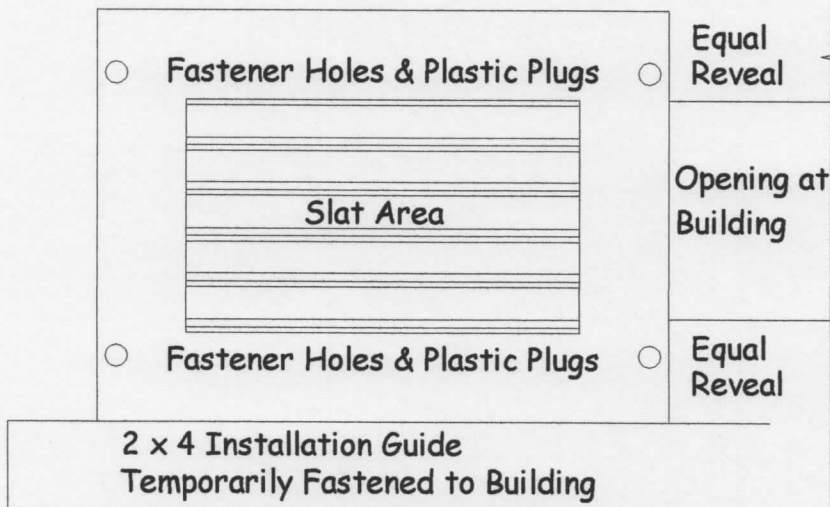

Section

